



# Box Edge Plus<sup>®</sup>

 **DACO**

(877) 247-3834 - [dacocorp.com](http://dacocorp.com)

# Box Edge Plus®

## ONE STORAGE SYSTEM DOES IT ALL

If your manufacturing facility, distribution center or business could have only one system for all of its storage and inventory demands, that system would be Box Edge Plus®. The wide offering of Box Edge Plus posts, shelves, components and accessories combine to accommodate a broad range of small or heavyweight storage items. Configure Box Edge Plus clip-type shelving components to meet your needs: maximize your cubic volume capacity and efficiently store small items with high-density drawer systems; improve inventory access and picking efficiency with shelves, dividers and bin fronts; enhance security and protect stored items with closed-type units or cabinets. Create exactly the storage system you want, with all the functionality you demand and the quality you deserve, at a highly competitive price. Borroughs Box Edge Plus – it's the one storage system that can do it all.

### BOX EDGE PLUS TYPES:

- OPEN
- CLOSED
- CLOSED SIDE, OPEN BACK
- DIVIDERS
- BINS
- CABINETS
- COUNTERS
- HIGH DENSITY DRAWERS
- MULTI-LEVEL/HIGH RISE

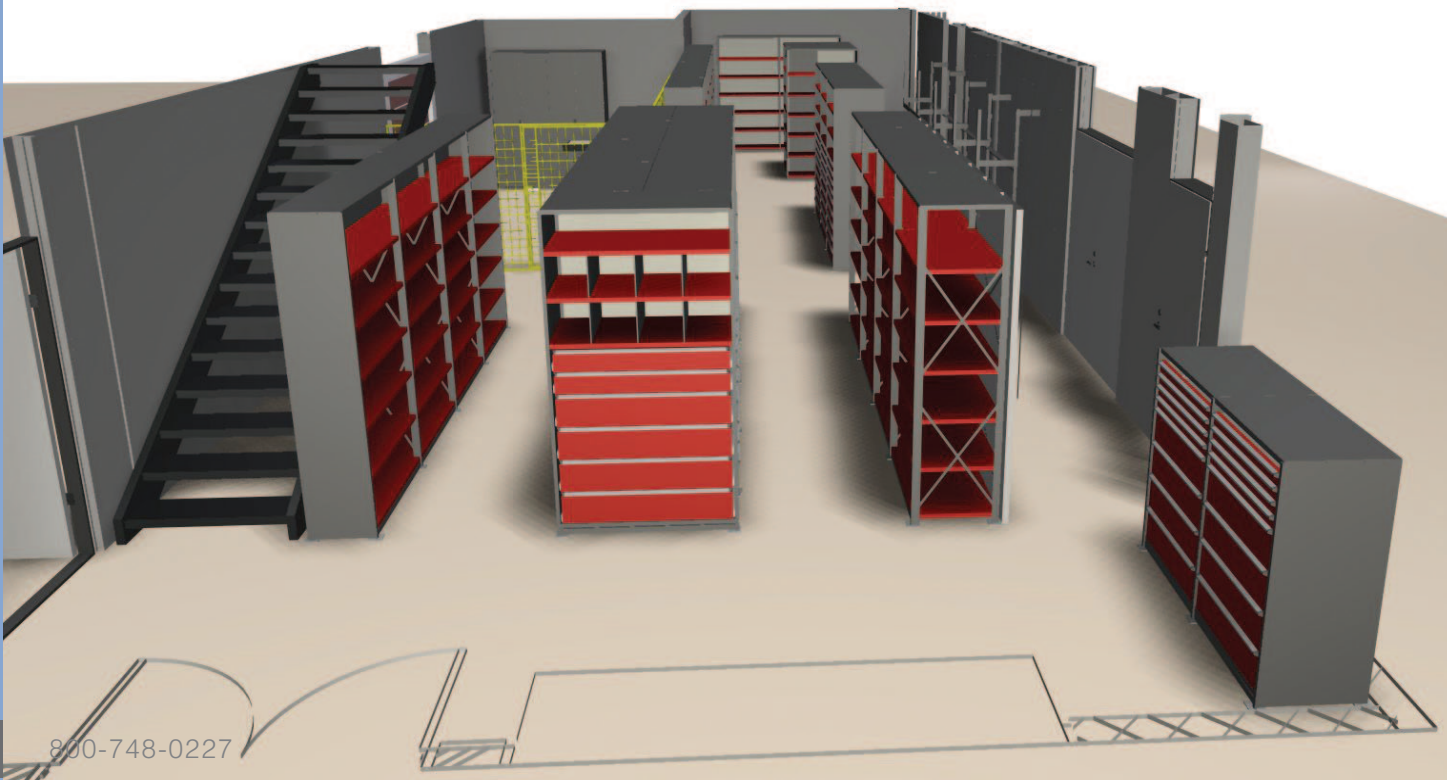

## BOX EDGE PLUS® DESIGN FEATURES

Our Box Edge Plus Shelf is designed for additional value and aesthetics without additional investment. The simplicity of Borroughs unique Box Edge design ensures structural rigidity as well as fast and easy assembly—saving time and money.

### BOX EDGE CONSTRUCTION

The front and rear edges of the shelf are formed into a closed, welded box shape, providing additional strength to handle impact or point loads. Box Edge Plus shelving is so strong it is used to support multi-level and high-rise storage systems.



### SHELF BRACKET

Shelf brackets provide wide load-bearing surfaces for quick and easy installation—without the use of tools, nuts or bolts. Shelves can even be rearranged without disturbing adjoining units.



### LAPPED AND WELDED CORNERS

Sturdy lapped and welded corners reinforce shelf strength and maximize load capacity.

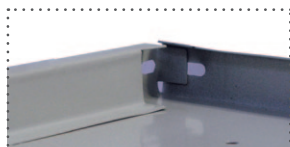

### CLEANER FRONT EDGE

The Box Edge Plus shelf has a clean front edge with no ridges or protrusions. Stored items slide smoothly on and the off shelves.



### BEADED POST

Borroughs beaded post reduces the front flange to create additional clearance for shelf space. The resulting wider shelf opening provides for more usable shelf space, while also giving a more aesthetic appearance.



### ANGLE POST

Our angle post is designed for maximum strength and stability, while at the same time providing flexibility for changing requirements. It is ideally suited for free-standing shelving units.

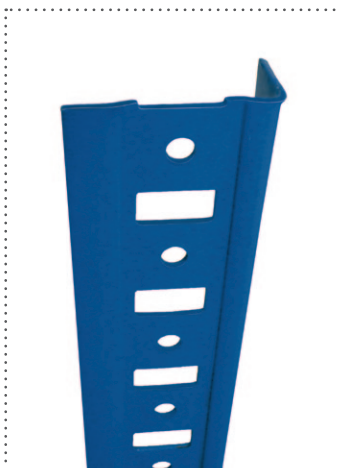

### HIGH-RISE POST

This post was developed by Borroughs engineers to allow maximum strength in a post compatible with the extensive line of accessories available from Borroughs. The result—an industry exclusive.



## BOX EDGE PLUS® DESIGN FEATURES

<p><b>HEIGHTS</b></p>	<p>Borrighs has seventeen standard post heights ranging from 3'3" to 16'3" for optimal use of your vertical space. Even taller units are possible using our many standard post splicers.</p>
<p><b>WIDTHS</b></p>	<p>Borrighs steel shelving is available in four standard widths to meet your specific storage needs. Protect your inventory investment and save valuable storage cube with the correct width shelving.</p>
<p><b>DEPTHS</b></p>	<p>Borrighs steel shelving comes in seven standard depths from 12" to 36" for efficient storage of a variety of items. Maximize your facility and stock picking efficiency with the optimum depth shelving.</p>
<p><b>ACCESSORIES</b></p>	<p>With the addition of our broad range of accessories, your shelving can be designed to meet your exact needs. Everything from motors to micro-chips can be stored safely and efficiently.</p>
<p><b>FAST ASSEMBLY</b></p>	<p>The unique design of the Borrighs shelf bracket ensures fast, easy assembly – saving time and money.</p>
<p><b>EASY ADJUSTMENT</b></p>	<p>Shelf adjustment is easy because the Borrighs shelf bracket captures shelves rather than "binding" them.</p>
<p><b>DURABLE FINISH</b></p>	<p>Borrighs Powder Coat Paint systems are state of the art, resulting in a durable, furniture quality finish—one of the best in the industry today.</p>
<p><b>ENVIRONMENTALLY CONSCIOUS</b></p>	<p>Our Green ISO 14001:2004 registered processes exceed current environmental standards and our powder coating contains no ingredients banned by the EPA. Borrighs' powder coat finished surfaces will not emit any chemical compounds or VOC's into the air during product use.</p>



## BASIC DATA

### HEIGHTS

Nominal height: One foot increments from 3'3" to 16'3".  
Actual height is the nominal height minus  $\frac{1}{4}" \pm \frac{1}{16}"$ .

#### NOTE:

Unit anchoring is recommended when the height to depth ratio exceeds 4.

*Example: 7'3" high x 18" deep unit has a height to depth ratio of 4.873 and should be anchored to a firm restraint such as a floor or wall.*

### WIDTHS

Nominal unit width: 24", 36", 42" or 48".  
Actual beaded post unit width is the nominal width plus  $1" + \frac{1}{16}"$ , - 0".  
Actual angle post unit width is the nominal width  $\pm \frac{1}{16}"$ , - 0".

### DEPTHS

Nominal depth: 12", 15", 18", 24", 30", 32" or 36".  
Actual beaded post unit depth is the nominal depth plus  $\frac{15}{32}" + \frac{1}{32}"$ , - 0" with beaded post in front and angle post in back.  
Actual angle post unit depth is the nominal depth  $+ \frac{1}{32}"$ , - 0".

### LENGTH OF RUN

Actual length of beaded post shelving run is nominal unit width  $+ \frac{1}{16}"$ , - 0" per unit plus  $\frac{1}{2}"$  for each row end. Actual length of angle post shelving run is nominal unit width  $+ \frac{1}{16}"$ , - 0" per unit.

### CLEAR SHELF OPENING

Actual clear opening between beaded posts is the nominal width minus 1". Actual clear opening between angle posts is the nominal width minus 2". Vertical clearance between shelves is equal to center-to-center shelf spacing minus  $1 \frac{7}{32}"$ .

### VERTICAL ADJUSTMENT

All shelves are adjustable on  $1 \frac{1}{2}"$  centers.



## CAPACITY TESTING PROCEDURES

Borroughs Box Edge Plus shelving weight capacities were derived using the standards set forth by American National Standards Institute ANSI-MH28.1-1997 and Shelving Manufacturers Association (SMA) Specification for the Design, Testing, Utilization, and Application of Industrial Grade Steel Shelving publication.

BOX EDGE PLUS® SHELF CAPACITY				
Size	Box Edge Plus 0 (24 g.)	Box Edge Plus 1 (22 g.)	Box Edge Plus 2 (20 g.)	Box Edge Plus 3 (18 g.)
24" x 12"	–	600 lbs.	–	–
36" x 12"	420 lbs.	600 lbs.	800 lbs.	1100 lbs.
42" x 12"	–	–	600 lbs.	1000 lbs.
48" x 12"	220 lbs.	400 lbs.	500 lbs.	800 lbs.
36" x 15"	–	600 lbs.	800 lbs.	1100 lbs.
42" x 15"	–	–	600 lbs.	1000 lbs.
48" x 15"	–	–	500 lbs.	800 lbs.
24" x 18"	–	600 lbs.	–	–
36" x 18"	400 lbs.	600 lbs.	800 lbs.	1200 lbs.
42" x 18"	–	–	600 lbs.	1000 lbs.
48" x 18"	210 lbs.	400 lbs.	500 lbs.	800 lbs.
24" x 24"	–	600 lbs.	–	–
36" x 24"	460 lbs.	600 lbs.	800 lbs.	1200 lbs.
42" x 24"	–	–	600 lbs.	1000 lbs.
48" x 24"	200 lbs.	400 lbs.	500 lbs.	800 lbs.
36" x 30"	–	–	600 lbs.	900 lbs.
42" x 30"	–	–	600 lbs.	1000 lbs.
48" x 30"	–	–	500 lbs.	750 lbs.
42" x 32"	–	–	650 lbs.	1000 lbs.
36" x 36"	–	–	400 lbs.	600 lbs.
42" x 36"	–	–	450 lbs.	600 lbs.

The capacities listed above are for uniformly loaded shelves. They were determined using testing procedures that conform to the standards of the Shelving Manufacturers Association. Shelves were tested for both capacity and acceptable deflection.

To simulate an evenly distributed load, hydraulic pressure was applied through a load cell onto eight shelves of each size and gauge we offer. The shelves were supported by our standard shelf brackets from our standard posts.

The pressure was applied to each shelf to the point of failure. The highest and the lowest failure load in each group of eight shelves was eliminated and a statistical analysis was done on the remaining size failure loads to determine an average.



Available in your choice of seven colors.  
Borrighs Standard Industrial Colors



B504 Blue

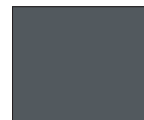

065 Industrial Gray



C386 Red

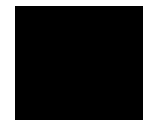

040 Black



F604 Pebble



445 White



161 Mist Gray

## OPEN-TYPE UNITS



Borroughs flexible, open-type shelving consists of posts, shelves and sway braces for added stability. It is ideal for general purpose storage and meets most storage requirements while providing maximum economy.

## CLOSED-TYPE UNITS (without backs)



Economical closed-type shelving without backs provides side support for those items that require it. The closed sides also give row ends a more finished appearance. Closed-type shelving without backs is often combined with closed units in back-to-back installations or used alone along walls.

36" Wide Units		
Starter Unit	5 shelves	Adder Unit
1000-3	36" x 12" x 7'3"	1001-3
1004-3	36" x 18" x 7'3"	1005-3
1006-3	36" x 24" x 7'3"	1007-3
Starter Unit	6 shelves	Adder Unit
1012-3	36" x 12" x 7'3"	1013-3
1016-3	36" x 18" x 7'3"	1017-3
1018-3	36" x 24" x 7'3"	1019-3
Starter Unit	7 shelves	Adder Unit
1024-3	36" x 12" x 7'3"	1025-3
1028-3	36" x 18" x 7'3"	1029-3
1030-3	36" x 24" x 7'3"	1031-3
Starter Unit	8 shelves	Adder Unit
1036-3	36" x 12" x 7'3"	1037-3
1040-3	36" x 18" x 7'3"	1041-3
1042-3	36" x 24" x 7'3"	1043-3

36" Wide Units		
Starter Unit	5 shelves	Adder Unit
2000-3	36" x 12" x 7'3"	2001-3
2004-3	36" x 18" x 7'3"	2005-3
2006-3	36" x 24" x 7'3"	2007-3
Starter Unit	6 shelves	Adder Unit
2012-3	36" x 12" x 7'3"	2013-3
2016-3	36" x 18" x 7'3"	2017-3
2018-3	36" x 24" x 7'3"	2019-3
Starter Unit	7 shelves	Adder Unit
2024-3	36" x 12" x 7'3"	2025-3
2028-3	36" x 18" x 7'3"	2029-3
2030-3	36" x 24" x 7'3"	2031-3
Starter Unit	8 shelves	Adder Unit
2036-3	36" x 12" x 7'3"	2037-3
2040-3	36" x 18" x 7'3"	2041-3
2042-3	36" x 24" x 7'3"	2043-3

48" Wide Units		
Starter Unit	5 shelves	Adder Unit
1000-4	48" x 12" x 7'3"	1001-4
1004-4	48" x 18" x 7'3"	1005-4
1006-4	48" x 24" x 7'3"	1007-4
Starter Unit	6 shelves	Adder Unit
1012-4	48" x 12" x 7'3"	1013-4
1016-4	48" x 18" x 7'3"	1017-4
1018-4	48" x 24" x 7'3"	1019-4
Starter Unit	7 shelves	Adder Unit
1024-4	48" x 12" x 7'3"	1025-4
1028-4	48" x 18" x 7'3"	1029-4
1030-4	48" x 24" x 7'3"	1031-4
Starter Unit	8 shelves	Adder Unit
1036-4	48" x 12" x 7'3"	1037-4
1040-4	48" x 18" x 7'3"	1041-4
1042-4	48" x 24" x 7'3"	1043-4

48" Wide Units		
Starter Unit	5 shelves	Adder Unit
2000-4	48" x 12" x 7'3"	2001-4
2004-4	48" x 18" x 7'3"	2005-4
2006-4	48" x 24" x 7'3"	2007-4
Starter Unit	6 shelves	Adder Unit
2012-4	48" x 12" x 7'3"	2013-4
2016-4	48" x 18" x 7'3"	2017-4
2018-4	48" x 24" x 7'3"	2019-4
Starter Unit	7 shelves	Adder Unit
2024-4	48" x 12" x 7'3"	2025-4
2028-4	48" x 18" x 7'3"	2029-4
2030-4	48" x 24" x 7'3"	2031-4
Starter Unit	8 shelves	Adder Unit
2036-4	48" x 12" x 7'3"	2037-4
2040-4	48" x 18" x 7'3"	2041-4
2042-4	48" x 24" x 7'3"	2043-4



## CLOSED-TYPE UNITS (with backs)



This Borroughs shelving type is enclosed on the back and sides to protect the contents, while providing a neat, finished appearance. Closed-type shelving is perfect for storing loose parts. Backs come standard in #445 White.

## CABINET-TYPE UNITS

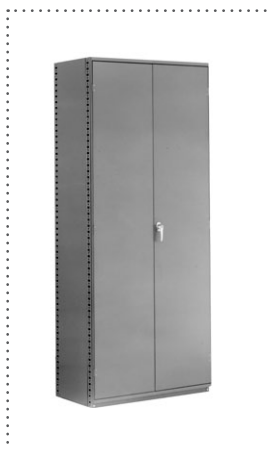

Fully enclosed cabinet-type shelving provides protection against dust and dirt. Backs come standard in #445 White. Doors lock for added security.

36" Wide Units		
Starter Unit	5 shelves	Adder Unit
3000-3	36" x 12" x 7'3"	3001-3
3004-3	36" x 18" x 7'3"	3005-3
3006-3	36" x 24" x 7'3"	3007-3
Starter Unit	6 shelves	Adder Unit
3012-3	36" x 12" x 7'3"	3013-3
3016-3	36" x 18" x 7'3"	3017-3
3018-3	36" x 24" x 7'3"	3019-3
Starter Unit	7 shelves	Adder Unit
3024-3	36" x 12" x 7'3"	3025-3
3028-3	36" x 18" x 7'3"	3029-3
3030-3	36" x 24" x 7'3"	3031-3
Starter Unit	8 shelves	Adder Unit
3036-3	36" x 12" x 7'3"	3037-3
3040-3	36" x 18" x 7'3"	3041-3
3042-3	36" x 24" x 7'3"	3043-3

Starter Unit	Size	Adder Unit
5012	36" x 12" x 7'3"	5013
5016	36" x 18" x 7'3"	5017

48" Wide Units		
Starter Unit	5 shelves	Adder Unit
3000-4	48" x 12" x 7'3"	3001-4
3004-4	48" x 18" x 7'3"	3005-4
3006-4	48" x 24" x 7'3"	3007-4
Starter Unit	6 shelves	Adder Unit
3012-4	48" x 12" x 7'3"	3013-4
3016-4	48" x 18" x 7'3"	3017-4
3018-4	48" x 24" x 7'3"	3019-4
Starter Unit	7 shelves	Adder Unit
3024-4	48" x 12" x 7'3"	3025-4
3028-4	48" x 18" x 7'3"	3029-4
3030-4	48" x 24" x 7'3"	3031-4
Starter Unit	8 shelves	Adder Unit
3036-4	48" x 12" x 7'3"	3037-4
3040-4	48" x 18" x 7'3"	3041-4
3042-4	48" x 24" x 7'3"	3043-4



Starter Unit	Size	Adder Unit
5112	36" x 12" x 7'3"	5113
5116	36" x 18" x 7'3"	5117

Note: All units come standard with Plus 2 shelves, unless otherwise stated.

## BIN-TYPE UNITS

Literally thousands of bin configurations can be designed from the Borroughs basic bin unit. Shown here are just a few of our most popular units. With Borroughs versatile bin-type shelving, you can have a storage system precisely customized to store your parts and small bulk items.

Shelf dividers and boxes separate items for easy access and identification. Backs come painted #445 white to reflect light in the unit, reducing picking time and errors.

Starter Unit	Size	Adder Unit
4012	36" x 12" x 7'3"	4013
4016	36" x 18" x 7'3"	4017
4018	36" x 24" x 7'3"	4019
Configurations		
6 Bins	12"w x 15"h	

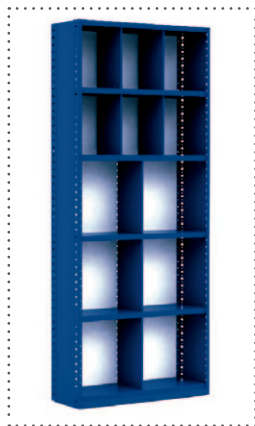

Starter Unit	Size	Adder Unit
4148	36" x 12" x 7'3"	4149
4152	36" x 18" x 7'3"	4153
4154	36" x 24" x 7'3"	4155
Configurations		
8 Bins	8"w x 9"h 1 1/2" high bin fronts	
2 Bins	8"w x 12"h 3" high bin fronts	
8 Bins	10"w x 9"h 1 1/2" high bin fronts	
2 Bins	10"w x 12"h 3" high bin fronts	



Starter Unit	Size	Adder Unit
4036	36" x 12" x 7'3"	4037
4040	36" x 18" x 7'3"	4041
4042	36" x 24" x 7'3"	4043
Configurations		



Starter Unit	Size	Adder Unit
4172	36" x 12" x 7'3"	4173
4176	36" x 18" x 7'3"	4177
4178	36" x 24" x 7'3"	4179
Configurations		
2 Bins	18"w x 9"h, 1 1/2" high bin fronts	
24 Bins	6"w x 6"h, 1 1/2" high bin fronts	
6 Bins	10"w x 9"h, 1 1/2" high bin fronts	
6 Bins	8"w x 9"h, 1 1/2" high bin fronts	

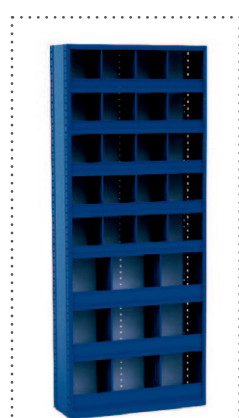

Starter Unit	Size	Adder Unit
4048	36" x 12" x 7'3"	4049
4052	36" x 18" x 7'3"	4053
4054	36" x 24" x 7'3"	4055
Configurations		
8 Bins	8"w x 9"h	
8 Bins	10"w x 9"h	
2 Bins	8"w x 12"h	
2 Bins	10"w x 12"h	



Starter Unit	Size	Adder Unit
4184	36" x 12" x 7'3"	4185
4188	36" x 18" x 7'3"	4189
4190	36" x 24" x 7'3"	4191
Configurations		

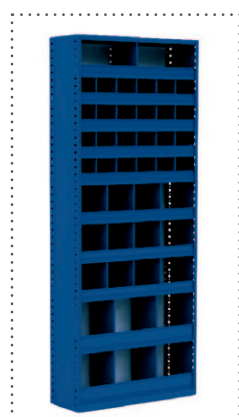

## COUNTER-TYPE UNITS

Service counters offer convenient storage space at the point of personal contact. Open and closed units can be ordered. Closed units come with #445 white backs to reflect light in the unit, increasing picking accuracy.



Note: All units come standard with Plus 2 shelves, unless otherwise stated.

### CLOSED UNITS

Starter Unit	Size	Adder Unit
<b>36" WIDE UNITS</b>		
7518	36" x 18" x 40"	7519
7524	36" x 24" x 40"	7525
7530	36" x 30" x 40"	7531
<b>42" WIDE UNITS</b>		
7618	42" x 18" x 40"	7619
7624	42" x 24" x 40"	7625



### OPEN UNITS

Starter Unit	Size	Adder Unit
<b>36" WIDE UNITS</b>		
7018	36" x 18" x 40"	7019
7024	36" x 24" x 40"	7025
7030	36" x 30" x 40"	7031
<b>42" WIDE UNITS</b>		
7118	42" x 18" x 40"	7119
7124	42" x 24" x 40"	7125



## BEADED POSTS

This post is designed for use in the front position to provide additional clear shelf space and a wider shelf opening. Made of 14 gauge hot-rolled steel, 2 3/4" x 1", in eight standard heights, with a rear flange that is spot-welded on 6" centers for added strength. Punched with rectangular holes on 1 1/2" centers for shelf positioning, and with round holes on 1 1/2" centers for the attachment of accessories and has an offset formed into the side flange for added strength and for shelf bracket clearance.

Catalog #	Size	Catalog #	Size



## ANGLE POSTS

Made of 13 gauge hot-rolled steel. 2 1/4" x 1" in 14 standard heights punched with rectangular holes on 1 1/2" centers for shelf positioning, with round holes on 1 1/2" centers for the attachment of accessories. And has an offset formed into the side

Catalog #	Size	Catalog #	Size
09534-099	3'3"	09534-093	9'3"
09534-098	4'3"	09534-092	10'3"
09534-097	5'3"	09534-091	11'3"
09534-096	6'3"	09534-090	12'3"
13112-099	7'0"	09534-089	13'3"
09534-095	7'3"	09534-088	14'3"
13112-096	8'0"	09534-087	15'3"



## HIGH-RISE POSTS

Made of 14 gauge steel, 2 3/4" x 2", the Box-Tee design is the heart of the high rise system. This post was developed by Borroughs engineers to allow maximum strength in a post compatible with the extensive line of accessories available from Borroughs. The result of this design effort is a post available in lengths up to 20' — an industry exclusive.

Catalog #	Size
14917-000	7'3"
14917-001	8'3"
14917-002	9'3"
14917-003	10'3"
14917-004	12'3"
14917-005	15'3"



## BEADED POSTS-CLOSED SIDES

Consists of a 24 gauge steel side spot-welded to one beaded post in front and one angle post in the rear. The addition of an angle post bolted to the rear post will pro-

Catalog □	Size	Catalog □	Size
14938-000	6'3" x 12"	14938-020	9'3" x 18"
14938-006	7'3" x 12"	14938-026	10'3" x 18"
14938-012	8'3" x 12"	14938-003	6'3" x 24"
14938-018	9'3" x 12"	14938-009	7'3" x 24"
14938-024	10'3" x 12"	14938-015	8'3" x 24"
14938-001	6'3" x 15"	14938-021	9'3" x 24"
14938-007	7'3" x 15"	14938-027	10'3" x 24"
14938-013	8'3" x 15"	14938-010	7'3" x 30"
14938-025	10'3" x 15"	14938-016	8'3" x 30"
14938-002	6'3" x 18"	14938-022	9'3" x 30"
14938-008	7'3" x 18"	14938-028	10'3" x 30"



## ANGLE POSTS-CLOSED SIDES

Consists of a 24 gauge steel side welded between two standard posts. Forms a partition to the floor to enclose the side of a unit. Also used to finish off the end of a row of open-type shelving. Provides front-to-back stability. The addition of two angle posts will provide an intermediate closed side at minimum cost.

Catalog □	Size	Catalog □	Size
09608-098	3'3" x 12"	09608-037	14'3" x 18"
09608-091	4'3" x 12"	09608-035	15'3" x 18"
09608-077	6'3" x 12"	09608-088	4'3" x 24"
09608-070	7'3" x 12"	09608-081	5'3" x 24"
09608-063	8'3" x 12"	09608-074	6'3" x 24"
09608-056	9'3" x 12"	09608-067	7'3" x 24"
09608-049	10'3" x 12"	09608-060	8'3" x 24"
09608-039	13'3" x 12"	09608-053	9'3" x 24"
09608-097	3'3" x 15"	09608-046	10'3" x 24"
09608-076	6'3" x 15"	09608-042	11'3" x 24"
09608-069	7'3" x 15"	09608-040	12'3" x 24"
09608-062	8'3" x 15"	09608-038	13'3" x 24"
09608-055	9'3" x 15"	09608-036	14'3" x 24"
09608-096	3'3" x 18"	09608-034	15'3" x 24"
09680-089	4'3" x 18"	09608-094	3'3" x 30"
09608-082	5'3" x 18"	09608-066	7'3" x 30"
09608-075	6'3" x 18"	09608-059	8'3" x 30"
09608-068	7'3" x 18"	09608-045	10'3" x 30"
09608-061	8'3" x 18"	09608-093	3'3" x 36"
09608-054	9'3" x 18"	09608-072	6'3" x 36"
09608-047	10'3" x 18"	09608-065	7'3" x 36"
09608-043	11'3" x 18"	09608-058	8'3" x 36"
09608-041	12'3" x 18"	09608-044	10'3" x 36"

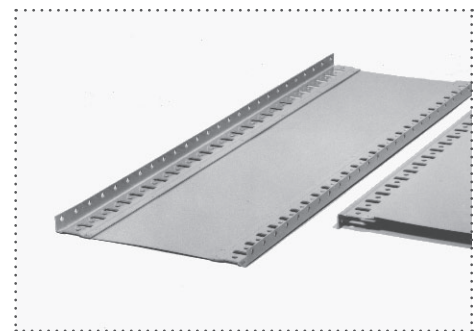

## SHELVING BACKS

Made of 24 gauge cold-rolled steel. Center row of holes accommodates back clips. For heights over 8'3", use combinations of smaller sizes, overlapped in the middle, with a minimum of a 1" inch overlap.

Catalog □	Size	Catalog □	Size
09551-099	24" x 7'3"	09550-096	42" x 6'3"
09547-097	36" x 3'3"	09551-096	42" x 7'3"
09548-097	36" x 4'3"	14867-096	42" x 8'3"
09549-097	36" x 5'3"	09547-095	48" x 3'3"
09550-097	36" x 6'3"	09548-095	48" x 4'3"
09551-097	36" x 7'3"	09549-095	48" x 5'3"
14867-097	36" x 8'3"	09550-095	48" x 6'3"
09547-096	42" x 3'3"	09551-095	48" x 7'3"
09548-096	42" x 4'3"	14867-095	48" x 8'3"



Catalog □	Size	Catalog □	Size
14918-000	4'3" x 12"	14920-000	7'3" x 12"
14918-001	4'3" x 15"	14920-001	7'3" x 15"
14918-002	4'3" x 18"	14920-002	7'3" x 18"
14918-003	4'3" x 24"	14920-003	7'3" x 24"
14918-004	4'3" x 30"	14920-004	7'3" x 30"
14918-005	4'3" x 32"	14920-005	7'3" x 32"
14919-000	5'3" x 12"	14921-000	8'3" x 12"
14919-001	5'3" x 15"	14921-001	8'3" x 15"
14919-002	5'3" x 18"	14921-002	8'3" x 18"
14919-003	5'3" x 24"	14921-003	8'3" x 24"
14919-004	5'3" x 30"	14921-004	8'3" x 30"

## SIDE PANELS (HIGH-RISE ONLY)

Borroughs side panels consist of 24 gauge cold-rolled steel which, when bolted to the high-rise posts, form a partition from the top of the unit to the floor, enclosing the side of a unit. Also, used to finish off the end of a row of open-type shelving. Provides front-to-back stability. Heights to 8'3" are available in one-piece construction.



## BACK ATTACHMENT KIT (HIGH-RISE ONLY)

Consists of four 12 gauge attachment brackets and hardware. Provides the secure attachment of backs or back

Catalog □	Description
14926-000	Back Attachment Clip
<ul style="list-style-type: none"> <li>• Four brackets per kit.</li> <li>• One kit needed per pair of braces.</li> </ul>	

## BACK PANELS FOR SPECIAL HIGH-RISE POST APPLICATIONS

ONLY for use with beaded post units on front and back. Made of 24 gauge cold-rolled steel. For heights over 8'3", use combinations of smaller sizes, overlapped in the middle. High-Rise Back Panels cannot be used on standard angle posts. Most High-Rise applications use Borroughs standard back panels above. Please contact your Borroughs representative for details.

## CROSS BRACES (BACK & SIDES)

Made from  $\frac{3}{4}$ " x 12 gauge band steel, cross braces add structural rigidity to open-type units. Available for sides and backs. All cross braces attach on 30" vertical centers and are bolted in center.

Catalog □	Length	Description
13826-000	24"	Back Brace
13828-000	36"	Back Brace
05017-815	42"	Back Brace
05165-815	48"	Back Brace
05019-815	12"	Side Brace
05583-815	15"	Side Brace
05020-815	18"	Side Brace
13829-000	24"	Side Brace
13830-000	30"	Side Brace
10445-000	32"	Side Brace
13831-000	36"	Side Brace



## FACE BRACES

Made of sturdy 11 gauge steel. Often used when units must be accessible from front and back, precluding the use of back cross braces. Furnished in pairs for both angle and beaded posts.

### BEADED FACE BRACE

Catalog □	Description
-----------	-------------



### ANGLE FACE BRACE

Catalog □	Description
-----------	-------------

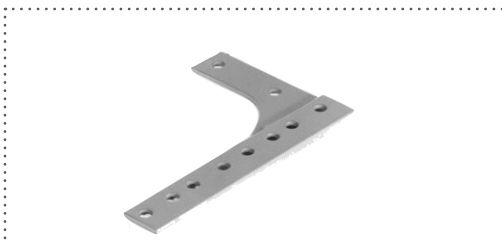

## BACK BRACES (HIGH RISE ONLY)

Made of hot-rolled  $\frac{3}{4}$ " 12 gauge band steel. All Borroughs back braces attach to posts on 30" centers and are bolted in the center. These braces attach to high-rise posts with back attachment brackets.

Catalog □	Size
14926-000	24"
14926-001	36"
14926-002	42"

## SIDE BRACES (HIGH RISE ONLY)

Made of  $\frac{3}{4}$ " 12 gauge band steel, the side braces add structural integrity to open-type units. All side braces attach directly to high-rise posts on 30" vertical centers.

Catalog □	Size
05019-815	12"
05583-815	15"
05020-815	18"
13829-000	24"
13830-000	30"

## BOX EDGE PLUS® SHELVES

Borroughs' Box Edge Plus shelf is designed for additional value and aesthetics without additional investment. The front and rear edges of the shelf are formed into a closed, welded box shape that, along with the lapped and welded corners, give the shelf maximum strength and rigidity. Plus, the box edge provides additional strength to handle impact or point loads. The Box Edge Plus shelf also has a cleaner, more attractive front edge and is fully compatible with all existing Borroughs' shelf brackets and posts. All shelves are punched on 1" centers for shelf dividers, except for 42" x 32" which have no divider holes. Four shelf supports brackets are provided for each shelf.

Size	Box Edge Plus 0 (24 g.)	Box Edge Plus 1 (22 g.)	Box Edge Plus 2 (20 g.)	Box Edge Plus 3 (18 g.)
24" x 12"	–	10437-000	–	–
36" x 12"	10448-001	10437-001	10428-001	10419-001
42" x 12"	–	–	10428-002	10419-002
48" x 12"	10448-004	10437-003	10428-003	10419-003
36" x 15"	–	10446-001	10429-001	10420-001
42" x 15"	–	–	10429-002	10420-002
48" x 15"	–	–	10429-003	10420-003
24" x 18"	–	10439-000	–	–
36" x 18"	10448-002	10439-001	10430-001	10421-001
42" x 18"	–	10439-002	10430-002	10421-002
48" x 18"	10448-005	10439-003	10430-003	10421-003
24" x 24"	–	10441-000	–	–
36" x 24"	10448-003	10441-001	10432-001	10423-001
42" x 24"	–	–	10432-002	10423-002
48" x 24"	10448-006	10441-003	10432-003	10423-003
36" x 30"	–	–	10434-001	10425-001
42" x 30"	–	–	10434-002	10425-002
48" x 30"	–	–	10434-003	10425-003
42" x 32"	–	–	10435-002	10426-002
36" x 36"	–	–	10436-001	10427-001
42" x 36"	–	–	10436-002	10427-002
48" x 36"	–	–	10436-003	10427-003



### SHELF SUPPORT BRACKETS

Unique, non-binding, saddle-type brackets let you install and later adjust shelves quickly and easily, without disturbing other shelves. They provide twice the support area of most other shelf supports.

Catalog □	Description
-----------	-------------



### HARDWARE

Unless otherwise stated, all necessary hardware is included in the catalog □ and will be shipped as part of the total hardware requirement. Borroughs uses only Grade 5 bolts for all bolted, structural connections.



## FIXED SHELF DIVIDERS

Made of 22 gauge steel, flanged at top, bottom and back for added strength. Provides a rigid partition between compartments. Front edge has a  $\frac{3}{8}$ " bead for extra rigidity and to protect hands. Attaches with push stud fasteners (included). For additional fasteners use part number 47955-01.

Catalog □	Size H x D	Catalog □	Size H x D
05599-807	6" x 12"	14374-000	16 1/2" x 18"
05606-807	9" x 12"	05629-807	18" x 18"
05613-807	12" x 12"	05643-807	24" x 18"
05620-807	15" x 12"	05602-807	6" x 24"
05627-807	18" x 12"	05609-807	9" x 24"
05600-807	6" x 15"	05616-807	12" x 24"
05607-807	9" x 15"	05623-807	15" x 24"
05614-807	12" x 15"	05630-807	18" x 24"
05621-807	15" x 15"	05637-807	21" x 24"
05628-807	18" x 15"	05644-807	24" x 24"
05601-807	6" x 18"	05604-807	6" x 36"
05608-807	9" x 18"	05611-807	9" x 36"
05615-807	12" x 18"	05618-807	12" x 36"



## SLIDING SHELF DIVIDERS

Made of 22 gauge steel, snaps into place over front and rear shelf flanges. Holds position firmly yet slides easily along the shelf to allow spacing changes to be made quickly.

Catalog □	Size H x D	Catalog □	Size H x D
14745-000	4 1/2" x 12"	14745-002	4 1/2" x 18"
14745-004	6" x 12"	14745-006	6" x 18"
14745-001	4 1/2" x 15"	14745-003	4 1/2" x 24"
14745-005	6" x 15"	14745-007	6" x 24"

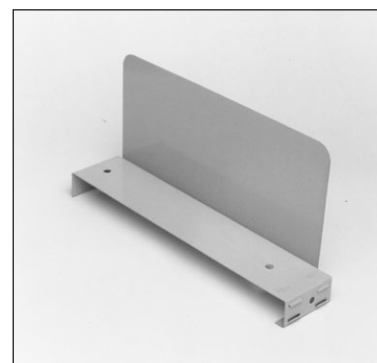

## ANGLE SHELF DIVIDERS

Made of 22 gauge steel flanged at bottom and punched for attachment to shelves. Attaches with push studs. Adjustable on 2" centers.

Catalog □	Size H x D	Catalog □	Size H x D
05490-842	1 1/2" x 12"	05492-842	1 1/2" x 18"
05493-842	3" x 12"	05495-842	3" x 18"



## SHELF BOXES

Made of 20 gauge cold-rolled steel. Sides are slotted at 1" intervals to receive partitions. Face has hand pull and label holder. Protective backstop prevents accidental removal of box from shelf. All shelf boxes are 4 5/8" high. Partitions are not included with shelf boxes. A shelf lock should be used on shelves immediately above boxes.

Catalog □	Size W x D	Catalog □	Size W x D
05339-808	5 9/16" x 11"	05353-808	11" x 17"
05345-808	8 3/8" x 11"	05342-808	5 9/16" x 23"
05351-808	11" x 11"	05349-808	8 3/8" x 23"
05325-808	5 9/16" x 17"	05355-808	11" x 23"
05347-808	8 3/8" x 17"		



Catalog □	Size
05476-810	5"
05477-810	8"

### PARTITIONS FOR SHELF BOX (dividers)

Made of 22 gauge steel, partitions accept 7/8" labels. All partitions are 4 5/8" high. Not included with shelf boxes.



Catalog □	Description
-----------	-------------

### BOX GUIDES

Prevents shelf box from lodging behind front flange of post. Made of 18 gauge steel. Extends 5" back from front flange of post. Recommended when using shelf boxes and front angle posts.



Catalog □	Size
09615-097	36" x 1 1/2"
09616-097	36" x 3"

### BEADED POST BIN FRONTS

Used on front of shelves to keep items within the bin. Made of 18 gauge steel.

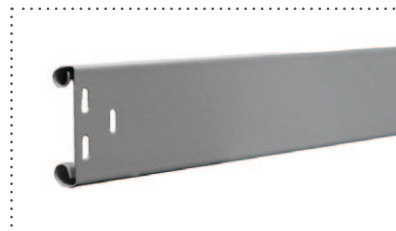

### ANGLE POST BIN FRONTS

Used on front of shelves to keep items within the bin. Made of 18 gauge steel except angle posts 1 1/2" and 3" which are 22 gauge. All bin fronts have a 1/2" bead on top and bottom edges. Clips provided for 1 1/2" angle post bin front. Bolts provided for all others.

Catalog □	Size	Catalog □	Size
05698-819	36" x 1 1/2"	09557-096	42" x 3"
05701-819	42" x 1 1/2"	09557-095	48" x 3"
05704-819	48" x 1 1/2"	09558-097	36" x 6"
09557-099	24" x 3"	09558-096	42" x 6"
09557-097	36" x 3"	09558-095	48" x 6"

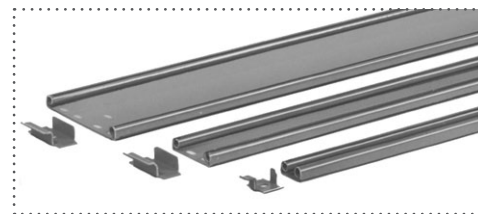

## ANGLE POST BIN FRONT CLIPS

Made of 14 gauge steel. Clips provided for 1 1/2" bin front; optional with 3" and 6" sizes.

Catalog □	Size
05707-835	1 1/2"
05708-836	3" and 6"

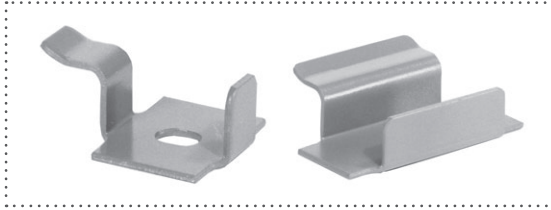

## CAPTIVE CLIP (HIGH RISE ONLY)

This optional clip provides for additional shelf security, yet allows quick and easy installation and adjustment of shelves without disturbing adjacent shelves or using tools.

Catalog □	Description
-----------	-------------



## SHELF LOCK

Prevents shelf from lifting up due to prying action from below when boxes are extended. Also locks shelf in place to allow transport of setup units.

Catalog □	Description
08703-823	Shelf Lock



## SHELF DIVIDER SUPPORTS

Made of 18 gauge steel. For use under ledge and counter tops to support dividers at the top. Angle formed and punched on 2" centers. **NOTE:** Divider should be 2" shorter than height of opening when divider supports are used. Furnished in pairs, front and rear.

Catalog □	Size
-----------	------

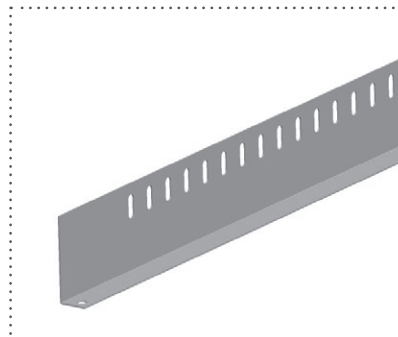

## MAGNETIC LABEL HOLDER

48" magnetic label holder can be easily moved as inventory changes from one location to another. Holds standard 7/8" labels and can be easily cut to any length.

Catalog □	Size
10460-000	48" x 1"



## LABEL HOLDERS

For shelves and long parts frames. Comes with label holder fasteners. Holds standard 7/8" high labels. For additional fastener use part number 47955-00

Catalog □	Size	Catalog □	Size
09556-099	24"	09556-096	42"
09556-097	36"	09556-095	48"



## LONG PARTS FRAMES

Made of 18 gauge steel. Offer ideal vertical storage of long parts and materials such as molding, pipes and bar stock. Adjust up and down within shelving on 1 1/2" centers. Fit open or closed shelving, 36" wide.

Spacer rods are designed so as not to dislodge during removal of material. Adjust horizontally on 1 1/2" centers. Label holders can be attached to either the top or the front face of the frame.

FRAMES		RODS	
Catalog □	W x D	Catalog □	Length
09576-099	36" x 12"	06238-860	12"
09576-098	36" x 18"	06239-860	18"

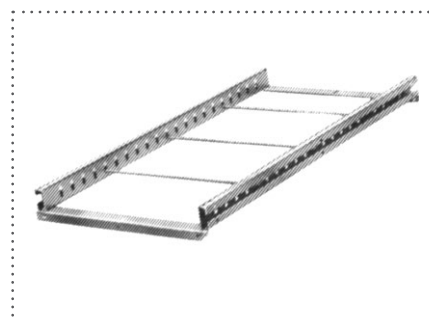

## BOLTLESS HANG BARS

Boltless hang bar kit includes rod and two special supports that fasten to posts of shelving unit. 48" rods can be field cut for 42" width.

Catalog □	Size
10140-000	24" x 18"
10140-004	24" x 24"
10140-001	36" x 18"
10140-005	36" x 24"
10140-002	48" x 18"
10140-006	48" x 24"

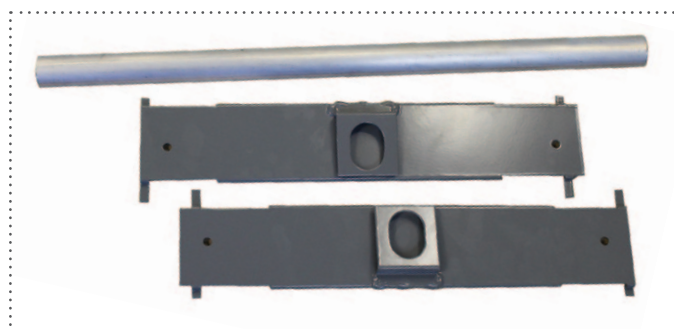

## SHELF SADDLE REINFORCEMENTS

"Hat"-shaped cross section, made of 11 gauge steel. Extends from side to side under center portion of shelf. Held in place by side flanges of the shelf, this piece reinforces the shelf center by transferring the load to the edges of the shelf. Must be used with shelf side supports.

Catalog □	Size
09610-097	36"
09610-096	42"
09610-095	48"



## SHELF SIDE SUPPORTS

Made of 14 gauge steel with formed post attachments. Reinforce shelves from front to back. Must be used when shelf saddle is used in conjunction with shelf brackets. Shelf rests on top flange. May also be used as a base strip on ends of rows of open shelving.

Catalog □	Size
09555-098	12"
09555-096	18"
09555-095	24"
09555-094	30"

## BASE STRIPS

Used to fill in the space between the bottom shelf and the floor. Made of 22 gauge cold-rolled steel. Prevents dirt and refuse from getting under the unit.

### ANGLE POST BASE STRIP

Catalog □	Length
09554-099	24"
09554-097	36"
09554-096	42"



### BEADED POST BASE STRIP

Catalog □	Length
09614-097	36"
09614-096	42"

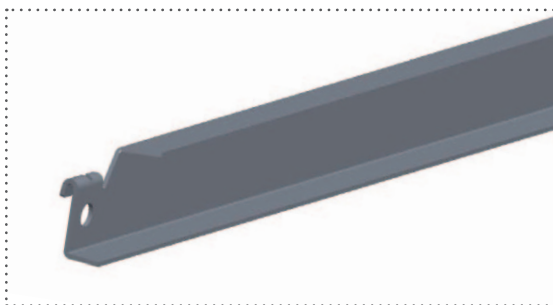
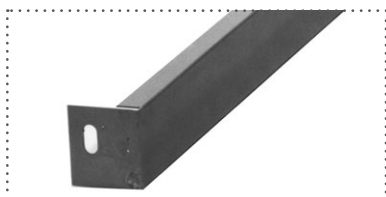

## POST SPLICERS

Used to combine two posts. Often used to add on to the vertical size of an existing installation or when heights greater than 20' (tallest one-piece post) are required.

### SINGLE ROW END BACK SPLICE KIT

Kit contains 1 post splicer and 1 intermediate splice bar.

### BACK TO BACK SPLICE BAR KIT

Kit contains 4 intermediate splice bars.

### BEADED POST SPLICER KIT

The beaded post splicer consists of a 1/4" steel plate at right angles to a 14 gauge 1" front plate which is attached with self-threading screws. Also includes splicer bar.

Catalog □	SPLICE KIT
14934-000	Beaded Post Splicer



### SINGLE ROW INTERMEDIATE SPLICE KIT

Kit contains 1 splice plate and 1 intermediate splice bar.

### BACK TO BACK ROW END SPLICE KIT

Kit contains 3 intermediate splice bars.

Catalog □	SPLICE KIT
02-B-09380-03	Back to Back

### HIGH-RISE POST SPLICER KIT

Provides front-to-back as well as lateral support. High-rise posts are joined with eight self-drilling screws and four bolts with the upper post resting on a 1/4" steel support plate. This system produces a splice internal to the high-rise post resulting in a neat, finished appearance.

Catalog □	SPLICE KIT
-----------	------------

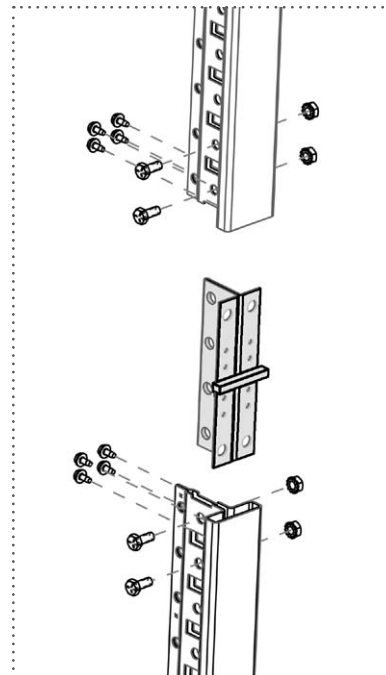

## ANGLE POST CORNER SPLICER

### CORNER SPLICE, FIGURE 1

Corner Splice to be used on single row shelving row ends utilizing Angle Post. The Splice mechanically attaches to front and side flanges of the post, giving support in two directions.

### SPLICE PLATE AND BAR, FIGURE 2

Splice Plate and Bar to be used in all shelving utilizing Angle Post in intermediate locations. Intermediate Splice Bar is used between two angle post sides in conjunction with the Splice Plate on the front of two angle post side by side.

### SPLICE BAR/INTERMEDIATE BAR FIGURE 3

10 gauge bar to be used with Beaded Post, High-Rise Post and Angle Post at all splice locations. Figure 3 showing Back to Back shelving Intermediate location (4 required per location) Bar to be mechanically attached.

Catalog □	Description
09545-099	Corner Splicer
09365-000	Splicer Bar
09366-000	Splicer Plate

Fig. 1 Corner Splicer  
 Fig. 2 Splice Plate & Bar  
 Fig. 3 Intermediate Splice Bar  
 Fig. 4 Row End Back to Back  
 Fig. 5 Beaded Post Slice Kit

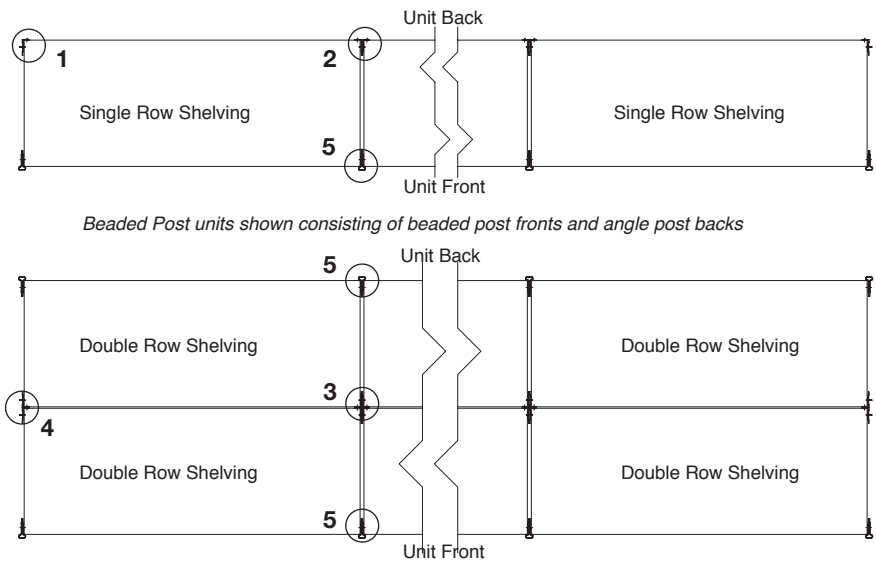
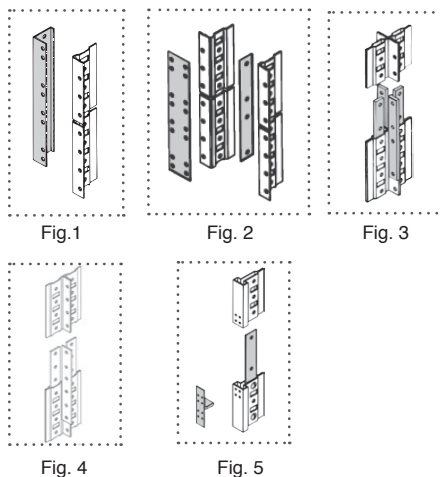

## CATWALK BEAMS (CROSS-AISLE TIES)

Available in 12 or 14 gauge. Channel beams require no brackets, attach directly to post. Designed to give maximum load bearing capabilities. Beams are available for angle and beaded posts, in four lengths. Supports decking at same height as mezzanine bracket and beam.

ANGLE POST		BEADED POST	
Catalog □	Size	Catalog □	Size
10135-000	30"	10134-000	30"
10135-001	36"	10134-001	36"
10135-002	42"	10134-002	42"

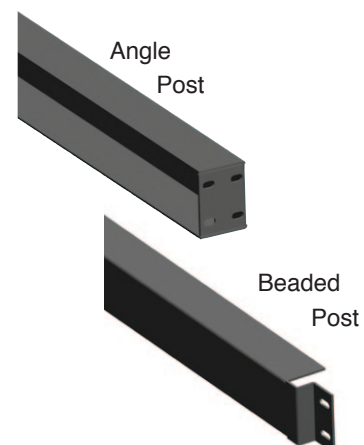

# BOX EDGE PLUS® SHELVING CAP SYSTEMS

The Borroughs Cap System is a hybrid of a catwalk and a full mat, specifically designed to lower material and labor costs. This is accomplished by the use of caps that fit over the top of the posts eliminating post splices.

To simplify things even more, face aisle beams are actually extensions of the cap itself. This further eliminates beams and brackets and replaces them with a labor saving cap beam.

Another advantage of the Borroughs Cap System is its ability to simplify the addition of a second level walkway and shelving to existing installation. Extra labor and splicer component expenses are eliminated. All that is necessary to add a second level of beaded post shelving is our simple cap system.

**NOTE:** The Cap Mezzanine System is NOT recommended for use in Seismic Zones 3 and 4.

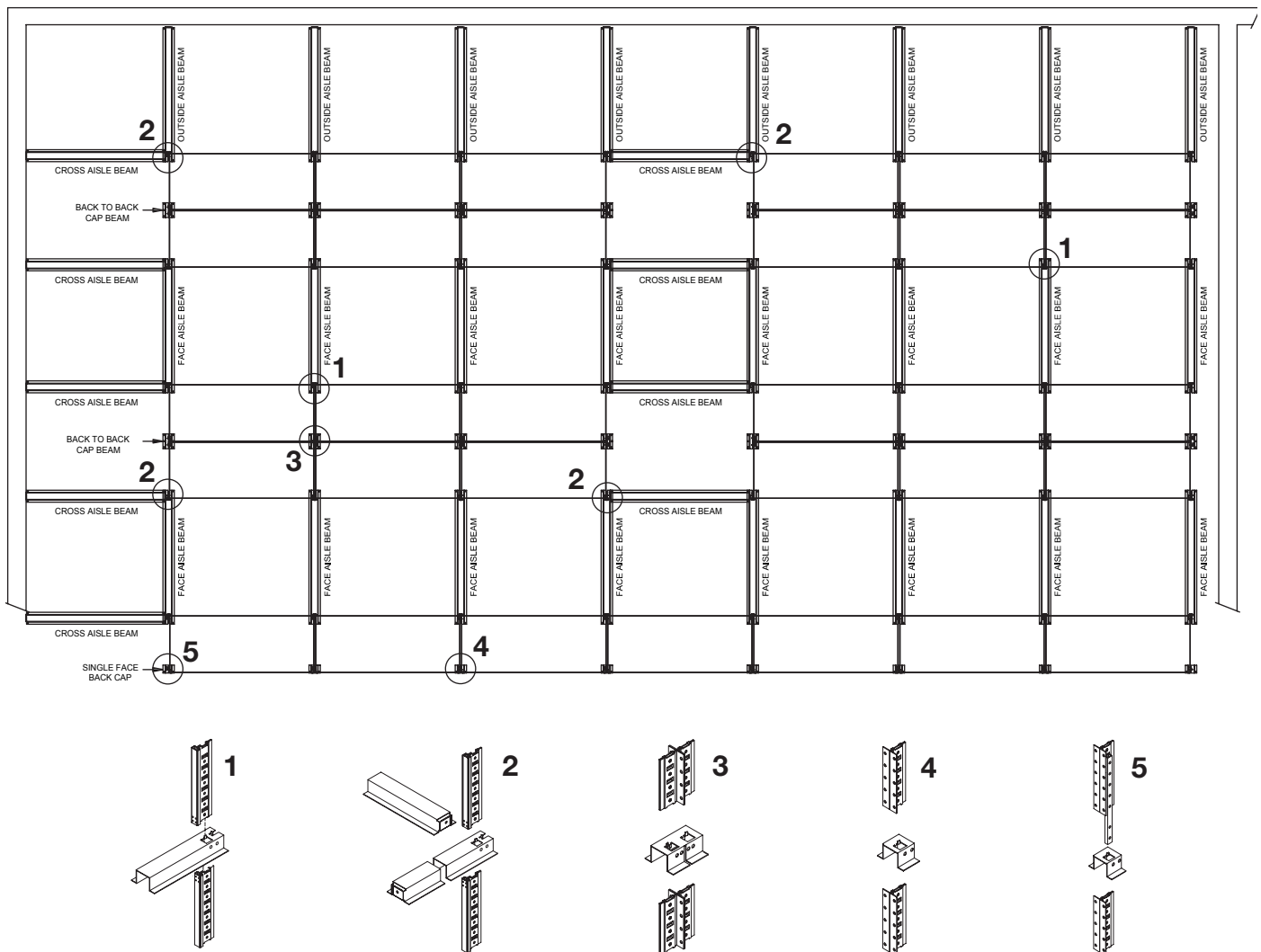

\* All Row Ends receive Row End Corner Splice Channel (5)



## FACE AISLE CAP BEAM

Used when an aisle is between two rows of shelving.

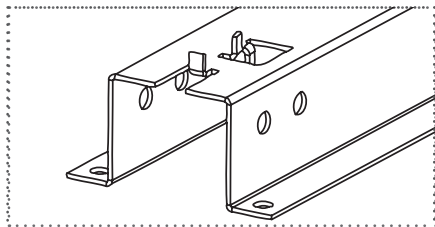

Catalog □	Size
10409-000	36"
10409-002	42"
10409-003	48"

**NOTE:** When using face aisle cap beams with angle posts, add 1" to aisle widths.

## OUTSIDE AISLE CAP BEAM

Used between the face of a shelving unit and an outside structure such as a wall or between the side of a shelving unit and an outside structure.

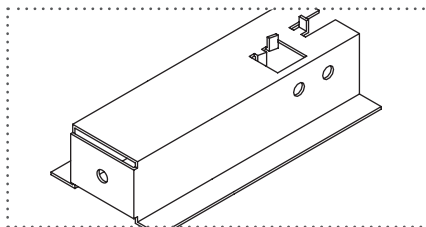

Catalog □	Size
10457-000	36"
10457-001	42"
10457-002	48"

## CROSS AISLE CAP BEAM

Used for cross aisles that run between units.

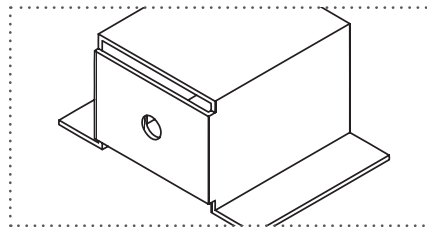

Catalog □	Size
10408-002	36"
10408-000	42"
10408-001	48"

## SINGLE FACE BACK CAP

Used on the back of a single face row of shelving to provide the cap needed for two rear angle posts to nest properly.

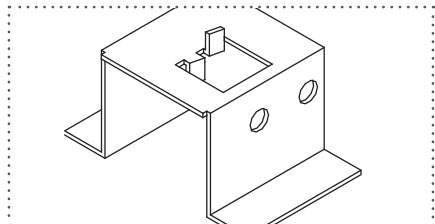

Catalog □
10418-000

## BACK-TO-BACK CAP

Used on back-to-back units to provide the cap needed for four rear angle posts to nest properly.

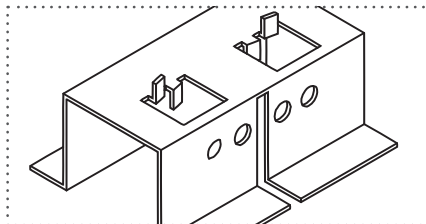

Catalog □
10417-000

## SINGLE FACE ATTACHMENT BRACKET

Used in conjunction with face aisle cap beams on single face rows to provide added stability for second level units of a single face row of shelving.

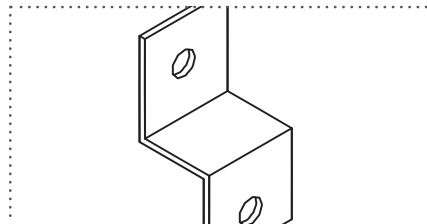

Catalog □
10455-000

## ROW END HAND RAIL

Used at aisle ends to keep personnel and equipment from falling off of the upper levels.

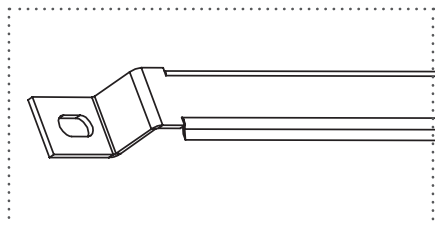

Catalog □	Size
10413-000	36"
10413-001	42"
10413-002	48"

## ROW END CORNER SPLICE CHANNEL

Used at the four outside corners of each row in conjunction with face aisle beams to provide added stability for second level units.

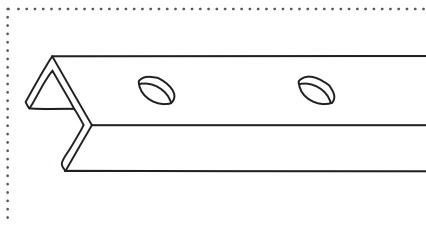

Catalog □	Description
10415-000	Row-End Corner Splice Channel

## ROW END KICK PLATE

Kick plates run along the end of an aisle next to the decking material to help prevent personnel and small items from falling off of upper levels.

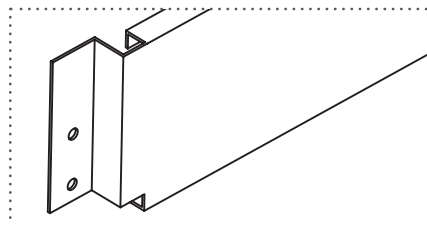

Catalog □	Size
10407-000	36"
10407-001	42"
10407-002	48"

Parts shown are for beaded post only. For Angle Post part numbers call your Borroughs representative.

FRAMED DOORS

Swing-type doors for angle post shelving are made of 20 gauge cold-rolled steel with a 3-point locking door handle. Doors consist of a fully contained welded steel frame, which bolts to the face of the unit simply and easily. Framed doors are available to fit shelving up to 7'3" tall. Two or more standard-sized doors are used for heights of 7'3". A special 4'0" high door is made for use above ledges. Doors will fit high density drawer units. Doors are not compatible with Beaded Post or Beaded Closed Sides. Adds 2 1/16" to depth of unit.

Catalog □	Size	Catalog □	Size
13402-001	36" x 3'3"	13402-002	42" x 3'3"
13404-001	36" x 4'0"	13402-014	42" x 6'3"
13402-005	36" x 4'3"	13402-018	42" x 7'3"
13402-013	36" x 6'3"	13402-003	48" x 3'3"
13402-017	36" x 7'3"	13402-015	48" x 6'3"



A. 1 pr. 48" x 7'3" doors.

B. 1 pr. 36" x 3'3" doors and 1 pr. 36" x 4' doors.

COUNTER BACKS

Made of 18 gauge, cold-rolled steel with a 5/8" return flange, positioned inward at the bottom, providing additional stiffness.

Catalog □	Size
09571-097	36" x 3'3"



COUNTER TOPS

Made of 16 gauge steel. Counter top has a 1" overhang on both front and rear faces. Converts a 3'3" section of shelving into a durable, heavy-duty counter. Tops 36" x 24" or larger have a saddle reinforcement welded in for added strength.

Catalog □	Size	Catalog □	Size
09570-099	36" x 18"	09569-098	42" x 24"
09570-098	42" x 18"	09569-097	36" x 30"



LEDGE TOPS

One piece, 16 gauge cold-rolled steel construction allows easy bolting to the top of ledge-type units.

Ledge top front has a 5/8" lip for enhanced strength and appearance. Sides attach to provide a finished appearance on a single unit or a flush joint with adjacent units.

Catalog □	Size	Catalog □	Size
09565-092	36" x 12"	09565-082	36" x 18"
09565-091	42" x 12"	09565-081	42" x 18"



## FOOT PLATES

### FOOT PLATE – FRONT

Made of 3 1/2" x 3 3/4" 12 gauge steel providing 13 1/8 square inches for post weight distribution and floor anchoring. Provides two 3/8" diameter holes for floor bolts, as well as a single hole for locating shim plates.



### FOOT PLATE – BACK-TO-BACK

Made of 3 3/4" x 6 1/4" 12 gauge steel providing 23 1/2 square inches for weight distribution. Also provides for floor anchoring with two 3/8" diameter holes for floor bolts as well as a single centering hole for locating shim plates.

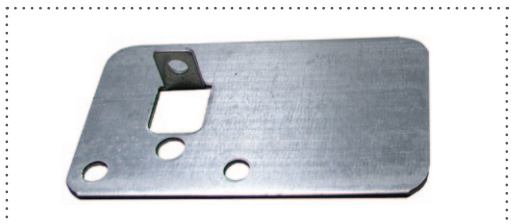

## POST FOOT ANGLE

Used to anchor angle posts to the floor.



## SHIM PLATES

### SHIM PLATE – FRONT

Made of 3 1/2" x 3 3/4" 16 gauge steel. Easily matched to foot plate with centering dimple and provides matching holes for floor-anchoring installations.

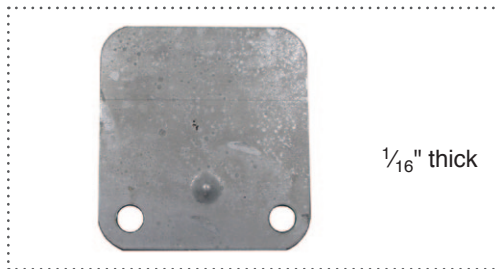

### SHIM PLATE – BACK-TO-BACK

Made of 3 3/4" x 6 1/4" 16 gauge steel. Easily matched to back-to-back foot plate with centering dimple and provides matching holes for floor-anchored installations.

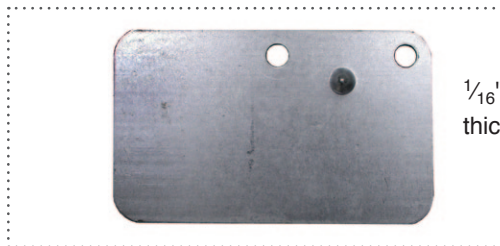

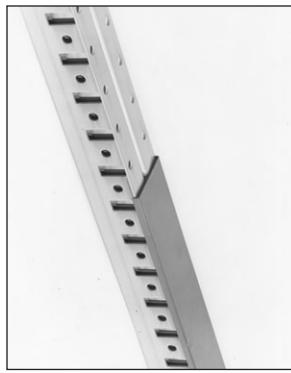

## POST COVERS

Create a smooth appearance by covering holes in posts and closed sides. Made of 20 gauge steel, does not interfere with shelf clips. Attached with concealed weld screws. Type 1 covers both flanges of corner posts. Type 2 covers front flanges of adjoining angle posts in intermediate positions. Type 3 covers holes on side flange of posts.

Size	Type 1 Catalog □	Type 2 Catalog □	Type 3 Catalog □
3'3"	13517-000	13518-000	13519-000
4'3"	13517-001	13518-001	13519-001
6'3"	13517-003	13518-003	13519-003
7'3"	13517-004	13518-004	13519-004
4'0"	—	13518-005	—
R.H. 4'0"	13517-005	—	13519-005

NOTE: 4'0" heights are used above ledges and for heights exceeding 7'3".  
For example: 8'3" post would be covered by a 4'3" and a 4'0" post cover.