

1. Fully Automatic Rotary Arm pallet Wrapping Machine



Standard Rotary Arm Pallet Wrapping Machine Model:X1000mp

- Less Space For Machine Installation
- Unlimited Maximum Pallet Weight
- PCB Control& Slewing Bearing Drive



2.Specification:

Model	Smart Wasp X1000mp	Spare Parts	Brand
Maximum wrapping speed	25-30 loads/hour Speed	Control	PCB (SMARTWASP Patent)
max pallet size	1.2x1.2m	Position sensor	SICK(Germany)
Maximum Wrapping Height	2000mm (2400mm 2600mm optional)	Photoelectric sensor	Autonics
Wrapping Speed	3-12RPM(Adjustable)	Travel Switch	OMRON(Japan)
Standard Film Width	500mm	Rotary drive Motor	SMARTWASP Brake Motor
Constant Film Delivery Force	Standard	Touch screen	X-Line(Taiwan)
Standard Pre-Stretch	250% pre-stretch	Switch	Schneider
Film Capacity	250mm Diameter	up and down motor	SMARTWASP
Film Delivery System	Motor control		
up and down drive system	Belt drive		
Top pressure function	optional	Special Process	Introduction
Machine Size	2.68x1.1x3.1m	Frame	Steel+Aluminum profile
machine weight	600KG	Printing	Metallic Paint
Voltage	220V/50/60HZ	Rotay Drive way	Slewing Bearing

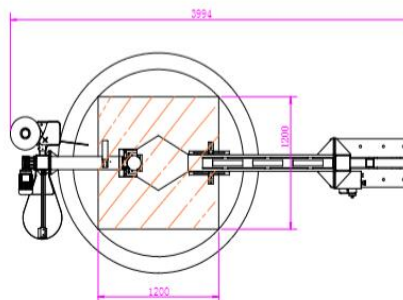
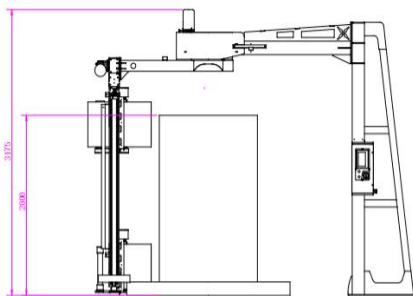

3. Machine Show:



MORE FEXIBLE

X1000mp - put the pallet on floor directly

- 1.No need ramp to load the pallet
- 2.No loading weight limited
- 3.Less Installation space

Durable Wrapping Arm

X1000mp use Slewing bearing Drive rotary arm works durable ,quiet and no need maintenance in future



High Level Wrapping Safety

1. the arm touch anything during wrapping ,whole machine will stop immediately

Intelligent operation system+PCB control system

- 1.Machine with operation guide solution ,machine teach you how to operte next step
- 2.if machine have problem ,on screen also have solution teach you how to slove the problem
- 3.PCB control ,maintenance more easier

